

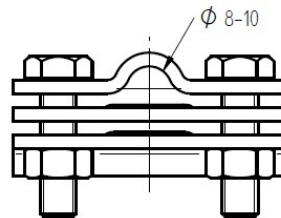

ELIT

Cross clamp V4A, 3-part, Ø8-10mm/Ø8-10mm



Cross clamp in acid-resistant steel, V4A, 3-part, Ø8-10mm/Ø8-10mm

Technical description

Cross clamp / Parallel clamp / T-clamp for round conductors Ø8-10 mm to Ø8-10 mm. All parts, including screws (4 x M8), are made of acid-resistant steel (V4A). The screws (4 x M8) must be tightened with a torque of 15 Nm. The product withstands short-circuit current up to 5.5 kA.

Advantages:

Cross clamp / Parallel clamp / T-clamp for round conductors Ø8-10 mm to Ø8-10 mm
All parts, including screws (4 x M8) are made of acid-resistant steel (V4A)
The product withstands short-circuit current up to 5.5 kA

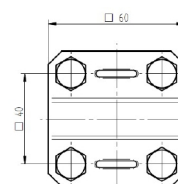

Product name/ Art.nr/ GTIN	ELIT KRYSS-KLEM-V4A-Ø810MM/ 40180041/ 7070810040476
According to:	EN IEC 62561-2
Type of connector	Connection terminal
Suitable for diameter round conductor	8 - 10 Millimetre
Clamping range	8 - 10 Millimetre
Material	Stainless steel 316 (V4A)
Surface protection	Hot-dip galvanized
Type of fastening screws	Hexagon screw